

# \$0 - 14103 156 Street, Edmonton

MLS® #E4437911

\$0

0 Bedroom, 0.00 Bathroom,  
Industrial on 0.00 Acres

Mistatim Industrial, Edmonton, AB

CURRENTLY UNDER CONSTRUCTION.

Pinnacle Park at 14103 156 Street offers flex industrial and retail showroom space for lease, with bays starting at 4,034 sq.ft.± and availability up to 73,153 sq.ft.±. The development includes five new buildings, with occupancy available Summer 2025. Each bay includes one grade door (12' x 14') and one dock door (9' x 10'), with 28' ceiling height and LED lighting. Zoned IB, the property includes 333 parking stalls and offers signage opportunities and a 10% tenant improvement allowance for office buildout. Located near 137 Avenue and 156 Street with access to St. Albert Trail, Yellowhead Trail, and Anthony Henday Drive.

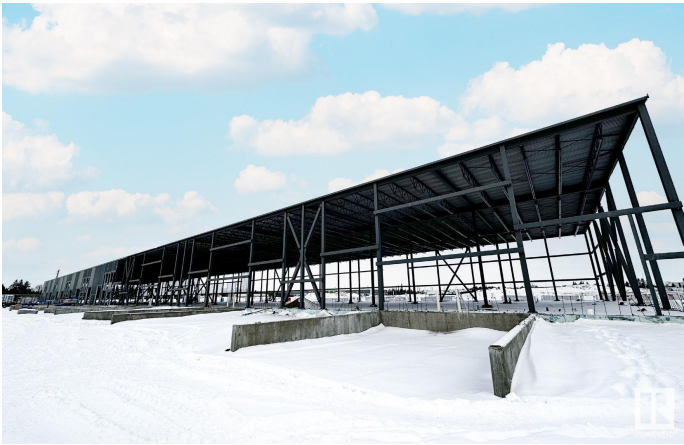

Built in 2025

Essential Information

|            |            |
|------------|------------|
| MLS® #     | E4437911   |
| Bathrooms  | 0.00       |
| Acres      | 0.00       |
| Year Built | 2025       |
| Type       | Industrial |
| Status     | Active     |

Community Information

|         |                  |
|---------|------------------|
| Address | 14103 156 Street |
| Area    | Edmonton         |

|             |                     |
|-------------|---------------------|
| Subdivision | Mistatim Industrial |
| City        | Edmonton            |
| County      | ALBERTA             |
| Province    | AB                  |
| Postal Code | T5V 0C6             |

**Exterior**

|              |       |
|--------------|-------|
| Exterior     | Mixed |
| Construction | Mixed |

**Additional Information**

|                |                |
|----------------|----------------|
| Date Listed    | May 22nd, 2025 |
| Days on Market | 59             |
| Zoning         | Zone 40        |

DATA IS DEEMED RELIABLE BUT IS NOT GUARANTEED ACCURATE BY THE REALTORS® ASSOCIATION OF EDMONTON. COPYRIGHT 2025 BY THE REALTORS® ASSOCIATION OF EDMONTON. ALL RIGHTS RESERVED.Trademarks are owned or controlled by the Canadian Real Estate Association (CREA) and identify real estate professionals who are members of CREA (REALTOR®, REALTORS®) and/or the quality of services they provide (MLS®, Multiple Listing Service®)

Listing information last updated on July 20th, 2025 at 3:02pm MDT